

YUNIL CNC Gear Hobbing Machine

HEAR 60/90

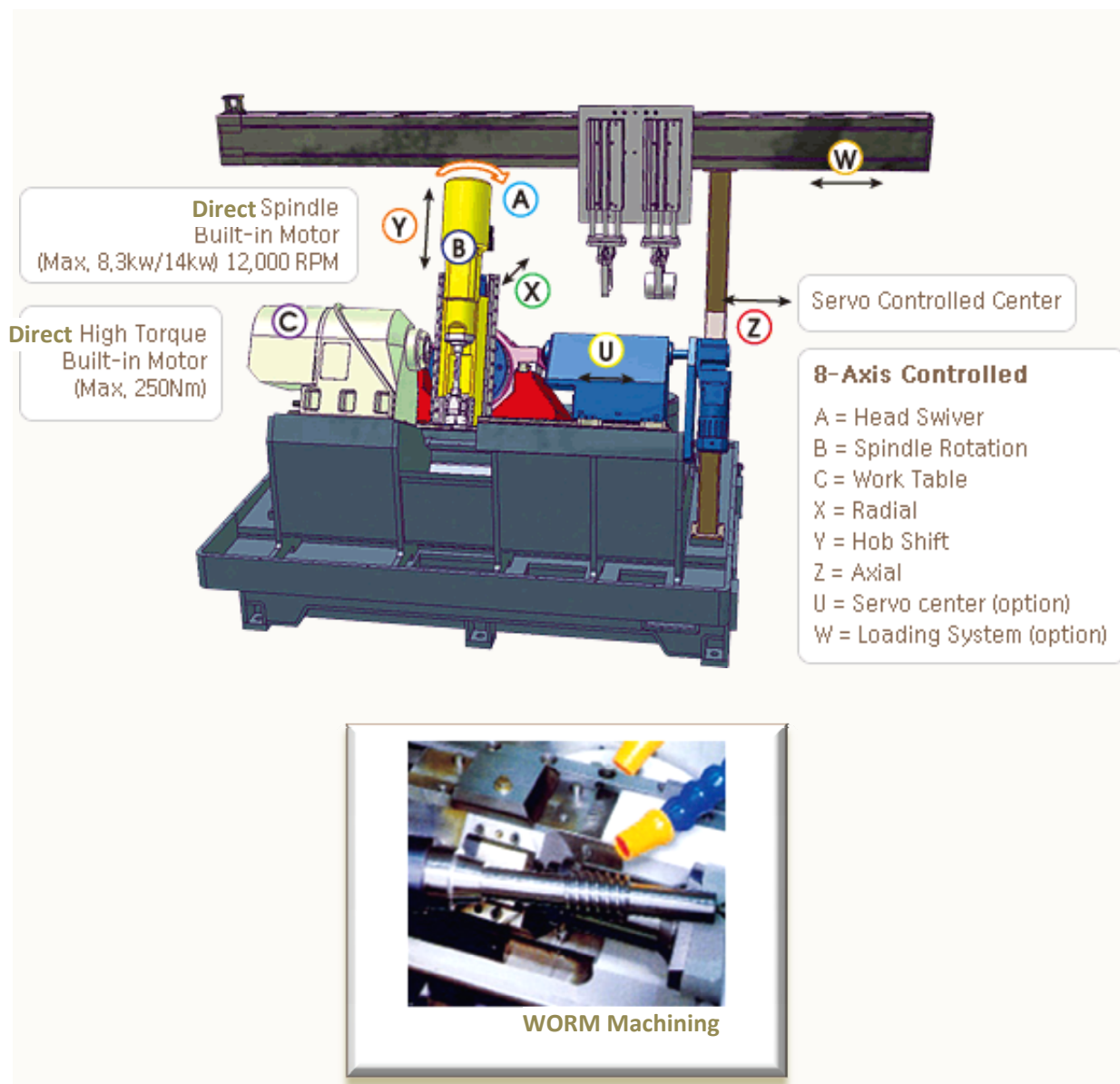

MACHINE FEATURES

- Wet or dry hobbing
- Swiveling range $+45^{\circ} / -115^{\circ}$ (Worm cutting available)
- High torque and spindle built-in motor on C.B-Axis
- Various kinds of automatic

STANDARD ACCESSORIES

1. Hob Arbor (Arbor, Sleeve, Collar, Nut)
: 2 Set (Ø22)
2. Coolant Supply Unit
3. Coolant Washing Unit
4. Hyd. Tank
5. Automatic Lubricating Pump (Intermittent Lub. Tank)
6. Full Splash Guard
7. X-Axis Retract at Power Failure
8. LED Work Light
9. Air-Conditioner
10. Leveling Kits
11. Standard Tools & Box
12. Operating Manual

OPTIONAL ACCESSORIES

1. Auto-Door (Air)
2. Steady Rest
3. Deburring Attachment
4. Oil mist Collector
5. Tool Pre-setter
6. Magnetic Chip Conveyor
7. Jig & Fixture
8. Loading / Unloading Attachment (Gantry Type)
9. In/Out Conveyor Unit
10. Dry Cutting Device
 - Inner SUS Splash Guard
 - Vacuum Suction Device
11. Transformer (30kVA)

MAJOR SPECIFICATIONS

Machine capacity	Unit	HERA 60	HERA 90
Max. workpiece dia	mm	60 / 80	90 / 100
Max. pitch		module 2	module 3
Radial. travel (X-axis)		80 (10~90)	90 (10~1000)
Hob spindle angle (A-axis)		+45° / -115°	+45° / -115°
Max. helix rpm (B-axis)	rpm	12,000	12,000
Table max. rpm (C-axis)	rpm	450	450
Working range		HERA 60	HERA 90
Vertical work range (Z-axis)		180	200
Center stroke range		320	320
Table diameter		Ø90	Ø90
Hob		HERA 60	HERA 90
Taper of spindle nose		HSK #32	HSK #32
Max. hob size (Dia×L)		Ø65 (Cutter Ø100)	Ø65 (Cutter Ø100)
Max. hob shift travel (Y-axis)		100	100
Rapid / Feed speed		HERA 60	HERA 90
Axial rapid (Z-axis)	mm/min	6,000	6,000
Radial rapid (X-axis)	mm/min	7,500	7,500
Max. hob shift travel (Y-axis)	mm/min	3,000	3,000
Hob head swiveling	deg/min	720	720
Motor		HERA 60	HERA 90
Total power	kVA	20	25
Main spindle motor	kw	8.3	14
Control system		SIEMENS 840Di	SIEMENS 840Di
Floor space	mm (W×L×H)	2,480×2,550×2,050	2,480×2,550×2,050
Weight (Approx)	ton	4.6	4.9

LAYOUT DIMENSION & WORKING RANGE

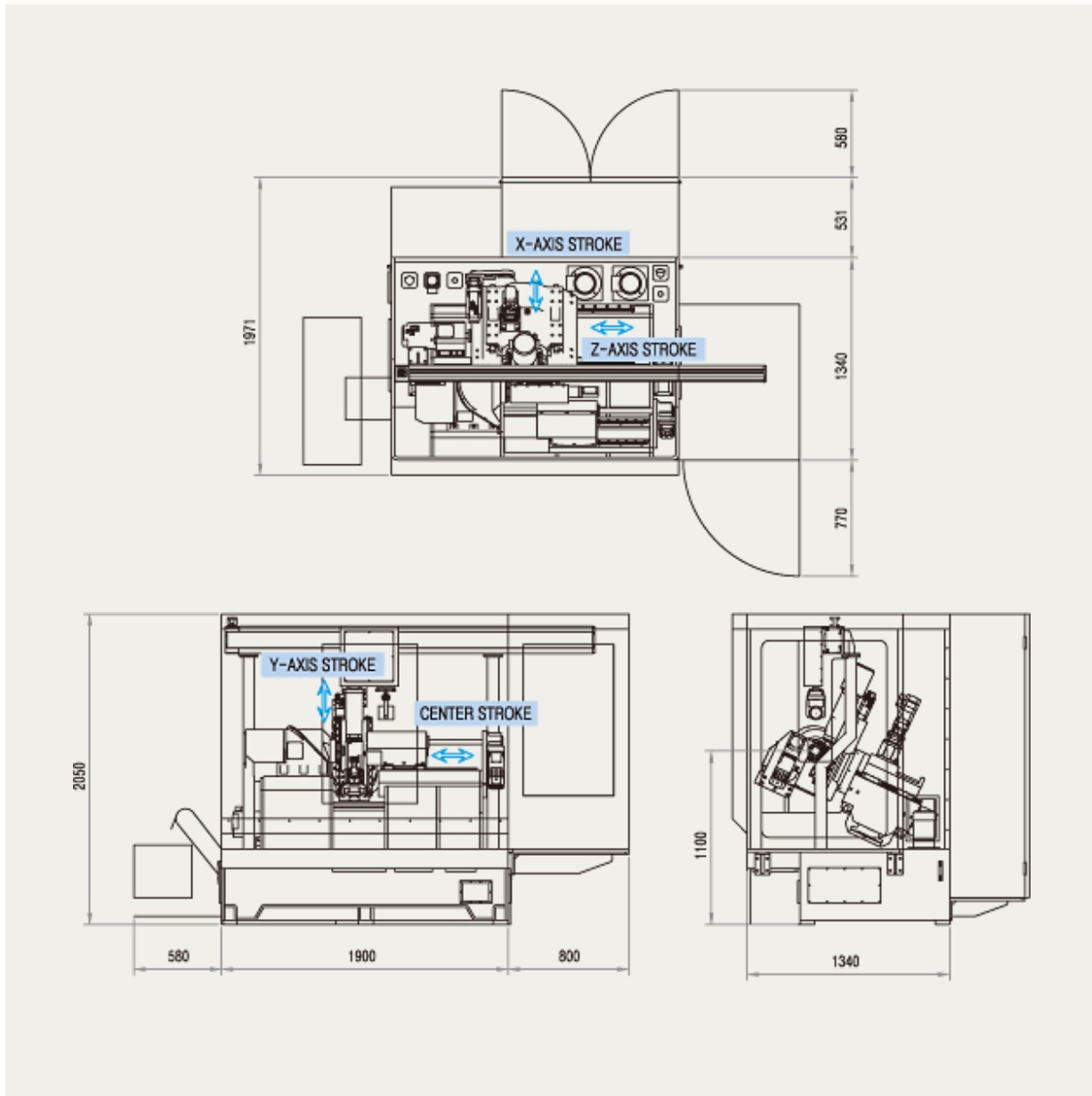

Range	HERA 60	HERA 90
X-AXIS STROKE	80 (10~90)	90 (10~100)
Y-AXIS STROKE	100	100
Z-AXIS STROKE	180	200
CENTER STROKE	320	320